



Toledo Bend

BMP Informer

Serving Sabine and Shelby Counties

Updating FOREST LANDOWNERS on Forestry and Water Quality Issues

TEXAS FOREST SERVICE Best Management Practices Project P.O. Box 310 Lufkin, TX 75902 hsimpson@tfs.tamu.edu

BMP Guidelines and Vendor Information

Want to know what the recommended guidelines are for implementing BMPs? Want to know where you can get the products used for certain water control structures and stream crossings? Need to do some repairs on already-existing BMPs in place on your property?

Go to the Texas Forest Service website to find technical assistance on installing BMPs:

http://texasforestservicetamu.edu/pdf/forest/water/bmp_handbook2000b.pdf

At this site, you can view and print the BMP Handbook and the Products and Vendor List.

Did you know . . .

Removing some of the shade alongside your woods roads will allow them to dry out more quickly after a rain and help keep them in great shape?

BMPs and Burning

Prescribed fire is a tool used to prepare sites for replanting, reduce accumulation of combustible materials, recycle forest nutrients, encourage growth of fire-adapted species, and aid in the general health of the forest. There are many guidelines and precautions that should be taken when doing a prescribed burn. Only trained, experienced individuals should conduct burns.

With fire come concerns of surface runoff, soil erosion and water quality. There are Best Management Practices that apply to burning and structures (such as firelanes) associated with it. Firelanes are permanent barriers that will be maintained over time for the specific purpose of stopping the spread of fire or for access to an area for the control of a fire.

If you are building or maintaining firelanes on your property, make sure they have water control devices where needed. Waterbars and wing ditches can be used on firelanes just like they are on dirt roads. When using wing ditches, make sure they do not divert the runoff water directly into a stream.

Reseeding the firelane is another method of preventing soil movement, and is also good for wildlife.

Mowing, rather than reblading, should be used, if feasible, to maintain firelanes over time in order to avoid exposing bare soil to potential erosion.

Another thing to keep in mind when burning – burning in a streamside management zone (SMZ) reduces the filtering capacity of the litter on the forest floor. Plan burns that minimize impacts on the SMZ. You can keep fire out of an SMZ by putting a temporary fireline around the perimeter

Timber Thieves Don't Use BMPs!

Some landowners have had timber cut and removed from their property without their permission.

If you suspect timber theft on your property or notice suspicious activity in your area, call the Timber Theft Hotline at 1-800-364-3470.

Help prevent timber theft –

- Clearly mark property boundaries, preferably with fencing.
- Gate all roads into the property.
- Ask your neighbors to report suspicious activity. Let them know when and where you are planning to have your timber cut.
- When having timber harvested, check the sale area where harvest is in progress to ensure unmarked trees are not cut.
- Know the value of your timber. Before making a timber sale, clearly mark and measure all trees to be included in the sale.
- Join a forest landowner association to improve your knowledge of forestry issues.
- Insist on a sale contract that includes Best Management Practices.

Improving My Land

Woods Road Maintenance

What could have prevented the washout that is depicted below?

Something as simple as maintaining the road ditches would have kept the water off of this road. The ditches were allowed to fill in with sediment causing the water to backup on the road.



A washout like this can result from failing to maintain the road ditch and wing ditches.

Preventative maintenance on your roads will help protect water quality and keep your access open all year. Be sure to check all of your water control structures, especially ditches and culverts on access roads to make sure that water can flow freely. Culverts can become clogged with debris and road ditches can fill in with sediment with time.

The long slow winter rains are coming to an end and will soon be replaced with the shorter duration and higher intensity spring and summer thunderstorms. Now is a good time to check your road systems. Preventative maintenance saves time and money when compared to reconstructing roads.

BMP Virtual Tour on TFS Website

A “Virtual Tour” of the BMP demonstration areas on the John Henry Kirby State Forest in Tyler County and the W. Goodrich Jones State Forest in Montgomery County can be found on the Texas Forest Service Home Page. Just go to:

<http://texasforestforests-service.tamu.edu/forest/water/default.asp> and click on either Jones or Kirby.

The Forest Tours page provides you with state-of-the-art examples of applying Best Management Practices. You will see photographs of open-top box culverts, low water crossings and culverts of different size, shape and composition. Products like geoweb and geogrid as well as examples of forest wetland determinations are also on-line.

All BMP demonstrations have photographs and a description of how the installations work to protect water quality. Detailed instructions for actually implementing the BMPs are also available.

In addition to the Virtual Tour, the TFS Home Page is a great place to keep updated on:

- BMP literature
- Training and workshops
- BMP Product and Vendor Guide
- BMP compliance
- Silviculture/Wetlands Regulatory Glossary
- Special events
- The Kid’s Korner
- Past issues of the Lake Livingston BMP Informer.

Just go to “Forest Management”, then click on Best Management Practices.

After taking the virtual tour, drop us an e-mail and let us know how you liked it.

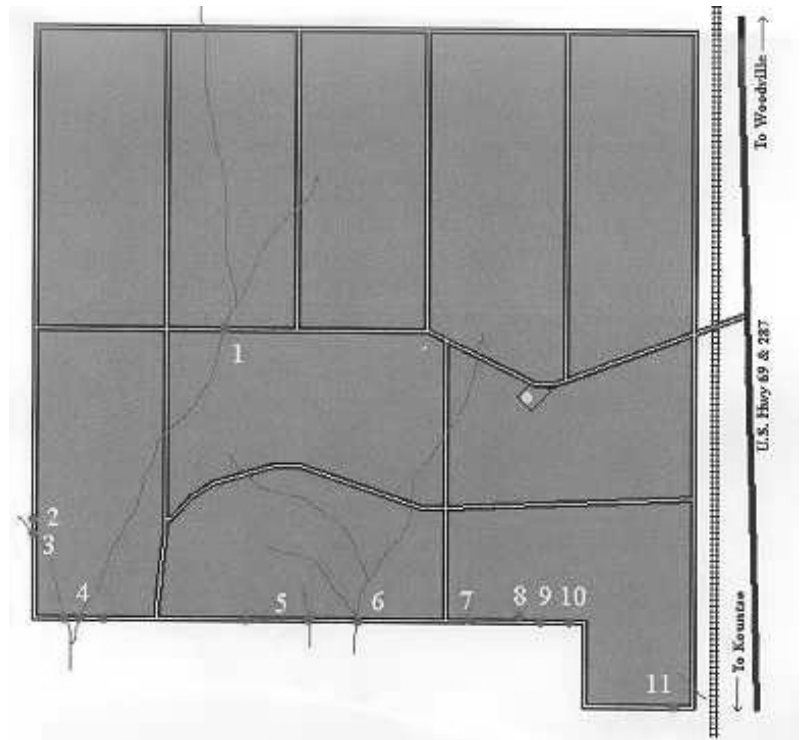

- Stop #1 Rock Low Water Crossing
- Stop #2 Cypress Open Top Box Culvert
- Stop #3 Creosote Timber Bridge
- Stop #4 Culverts
- Stop #5 Treated Open Top Box Culverts
- Stop #6 Geoweb Low Water Crossings
- Stop #7 Geogrid Underlay
- Stop #8 Wetland Designation
- Stop #9 Geogrid Underlay
- Stop #10 Cross Road Drainage
- Stop #11 Constructed New Road

Looking for a Good Logging Contractor?

The Texas Forest Service maintains a list of all logging contractors who have attended the TFS/TFA Forestry Best Management Practices Workshop. This list is available at any TFS district office.

You can also access a list of BMP-trained loggers on the Texas Forestry Association's website at <http://www.texasforestry.org>. Click on *Training Database*. TFA's list also shows the other courses completed by the loggers, including those with Pro Logger certification. By clicking on *Programs*, you can learn about the Pro Logger Accreditation Program, the Texas Logging Council and other TFA programs.

Distribution of the *Toledo Bend BMP Informer* is provided free of charge to forest landowners of Sabine and Shelby Counties. Funding has been provided through cooperation of the Environmental Protection Agency (EPA), the Texas State Soil and Water Conservation Board (TSSWCB) and the Texas Forest Service (TFS). PLEASE ADVISE US IF YOU WISH YOUR NAME REMOVED FROM OUR MAILING LIST.

The Texas Forest Service is an Affirmative Action/Equal Opportunity Employer committed to Excellence Through Diversity.



P. O. Box 310
Lufkin, TX 75902-0312

Phone: 936-639-8180

TDD Line: 1-866-419-4872